

# I.Dekk

## How to Select Proper End Caps For I.Dekk Tongue and Groove

To determine the correct end caps for a particular installation of I.Dekk T&G, look directly at the end of the deck boards where the caps will be installed and compare what you see to the images below.

### Right End Caps:

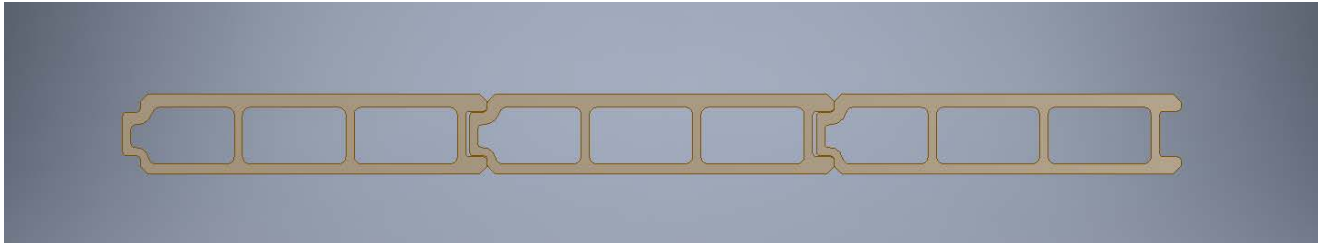

In the above image, the boards were installed starting at the right side and moving left. Note that the tongue of the board faces left and the groove of the board faces right. This installation will require **RIGHT END CAPS**.

Right end caps are marked with an “R” as well as an arrow indicating which way to install the end cap.

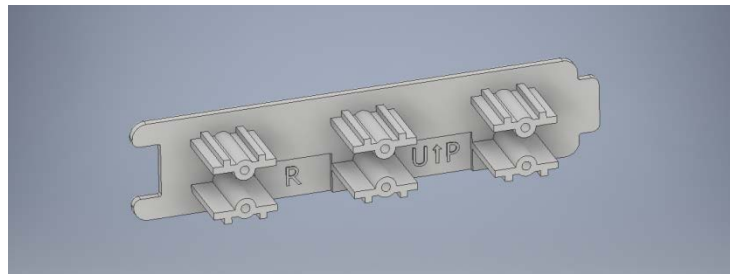

### Left End Caps:

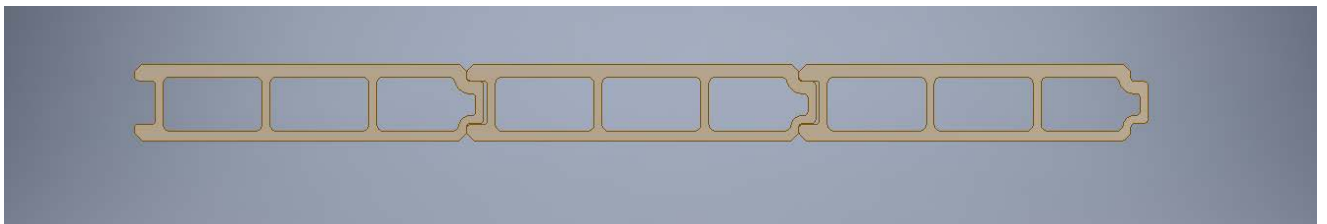

If your deck was installed starting from the left and moving right, then it should look like the image above. Note that the tongue of the board faces right and the groove of the board faces left. This installation will require **LEFT END CAPS**.

Left end caps are marked with a an “L” as well as an arrow indicating which way to install the end cap.

